

**LEGEND**

- 1" IRON PIN & CAP MARKED 'KLEINGERS' SET
- IRON PIN FOUND
- PIPE FOUND
- △ RAILROAD SPINE FOUND
- △ BUILDING SETBACK
- △ MINIMUM OPENING ELEVATION
- △ AREA OF LITTLE SUGARCREEK ROAD & FEEDWIRE ROAD BEING REDICATED BY THIS PLAT
- △ PORTION OF SANITARY SEWER EASEMENT BEING TACKLED BY THIS PLAT

**NOTES:**

- 1.) EACH LOT SHALL CONTAIN A FIVE (5) FOOT PRIVATE DRAINAGE EASEMENT ALONG EACH SIDE LOT LINE NOT PRESENTLY LABELED WITH AN EASEMENT AND A TEN (10) FOOT WIDE UTILITY AND PRIVATE DRAINAGE EASEMENT ALONG THE REAR LOT LINES UNLESS OTHERWISE NOTED.
- 2.) 5/8" IRON PINS ARE TO BE SET AT ALL LOT CORNERS, ANGLE POINTS, P.C'S AND P.T'S OF PROPERTY LINE CURVES UNLESS OTHERWISE NOTED.
- 3.) SEE SHEETS 6-9 FOR EASEMENTS.

CHARLES G. & CAROL R. WORMAN  
 P.O. BOX 360  
 4.5 ACRES (DEED)  
 SECTION ONE  
 TOWNSHIP ONE  
 P.B. 31, P.O.S. 1443-146A

LIFESTYLE COMMUNITIES BY  
 MILLER-VALENTINE AT SUGAR RIDGE LLC  
 P.O. BOX 203, P.O. 159  
 23.947 ACRES (DEED)

**CURVE TABLE**

CURVE	RADIUS	LENGTH	CHORD	DIRECTION	DELTA
C1	150.00	146.30	140.57	N85°25'54"W	55°35'50"
C4	200.00	103.66	104.44	N13°48'24"W	30°16'00"
C29	171.00	38.00	33.93	N45°58'27"W	17°02'46"
C31	221.00	53.40	51.27	N27°01'07"W	13°50'44"
C32	221.00	4.96	4.98	N42°22'00"W	171°17'
C33	32.00	22.94	22.45	N44°20'52"W	41°03'57"
C34	47.50	47.14	45.23	N28°28'48"W	95°29'23"
C35	47.50	44.01	42.46	N28°11'38"E	51°05'30"
C36	47.50	23.71	23.40	N27°04'51"E	31°01'00"
C37	47.50	40.17	34.86	S83°40'59"E	48°27'25"
C38	32.00	26.91	26.13	S88°10'22"E	49°11'23"
C39	137.00	27.80	27.78	N34°45'20"W	11°37'42"

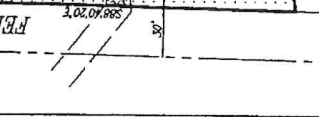

SUGAR RIDGE